

# Light Bi-Block

## Slot-in Shelves System



## Slot-in shelves system

- Medium-load capacity system for containers or goods in bulks. It can be completed with catwalks to obtain multi-functional installations for intensive utilization with the application of automated system.

### Light Bi-Block combinations

Shelving with tile planks

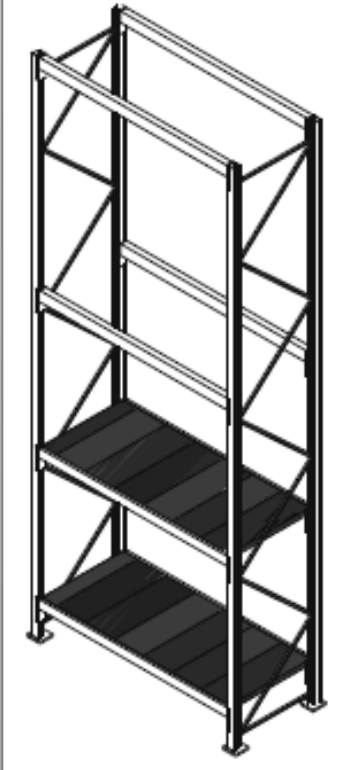

Shelving with catwalk

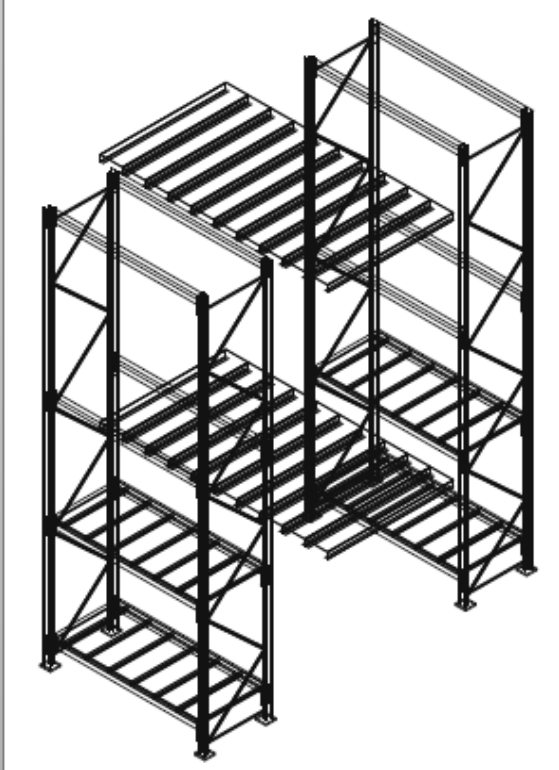

#### Material

##### Uprights, beams:

Sendzimir galvanized steel S350 GD UNI EN 10326

##### Stringers/diagonals, tiles:

Sendzimir galvanized steel S280 GD UNI EN 10326

##### Base plates:

steel S235 JR UNI EN 10025 – electro-galvanized



## Components

- The permitted load is understood as uniformly distributed over the two abutment uprights. Possible unbalanced loads over the tunnel length must be carefully studied in advance.
- Being "H" the height of the first beam from the floor, assume H as pitch distance between the next beams in case it might be higher.
- In order to ensure longitudinal stability, at least 2 pairs of beams must be present in vertical direction (3 pairs in case of jointed shoulders).
- Exclude the load over the beams fixed into the round when determining the type of profiles.

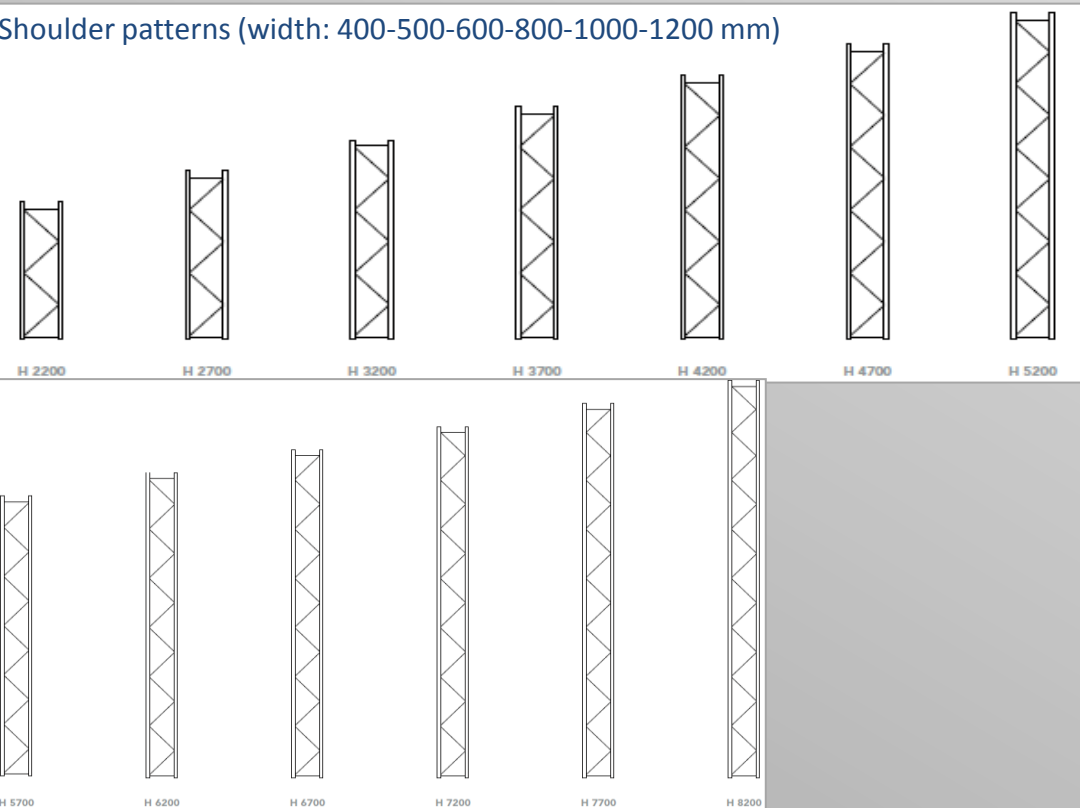

Abutments width	Cross beams			Diagonal beams		
	a (mm)	A (mm)	Weight (kg)	a (mm)	A (mm)	Weight (kg)
400	303	333	0,19	585	615	0,34
500	403	403	0,24	642	672	0,38
600	503	533	0,30	709	739	0,41
800	703	733	0,41	863	893	0,50
1000	903	933	0,52	1032	1062	0,59
1200	1103	1133	0,63	1211	1241	0,69

### Permitted abutments capacity

Beams inter-axis (mm)	S55/45B (kg)	S55/55B (kg)
600	4600	6500
900	4200	5800
1200	3700	4700
1500	3200	4100
1800	2900	3900
2100	2400	3200

Upright S55/45B

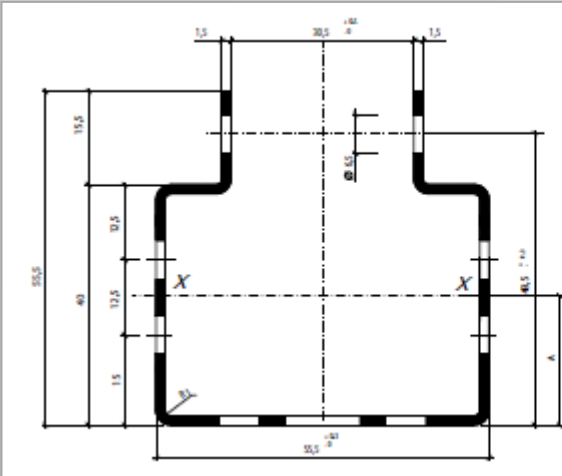

Upright S55/55B

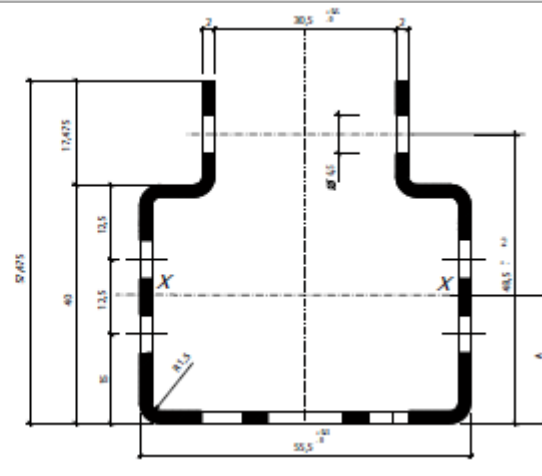

Cross and diagonal beam S55/45B and S55/55B

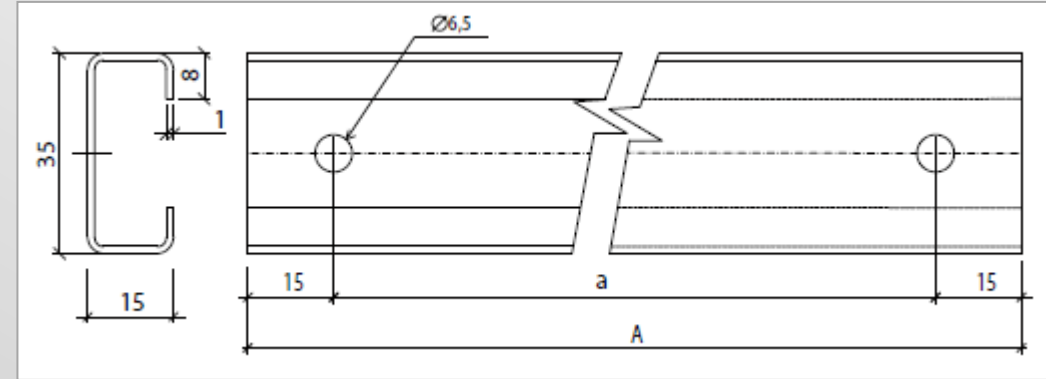

Scheme of cross and diagonal beams

Cross beam terminal spacer

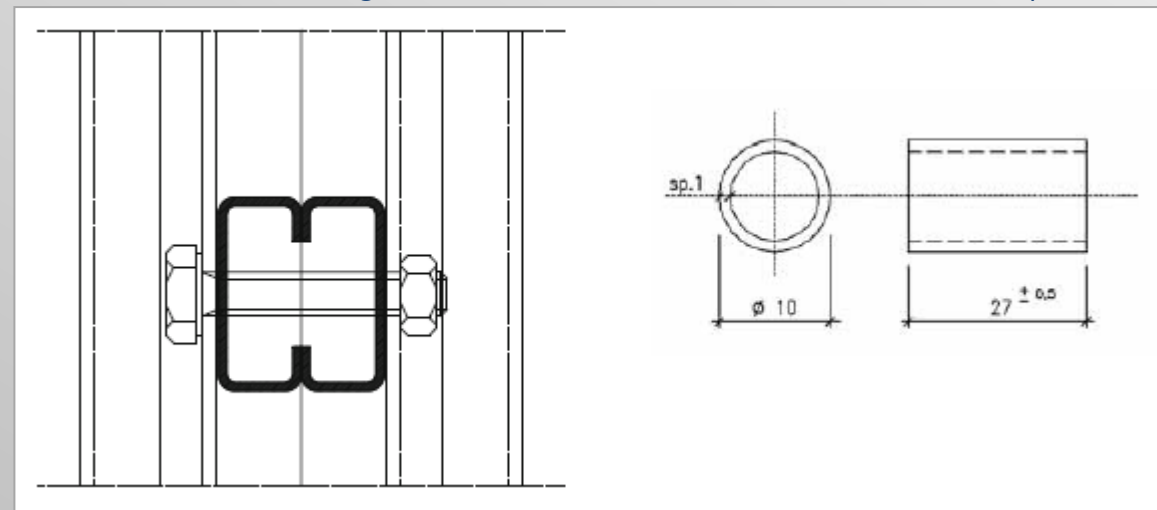
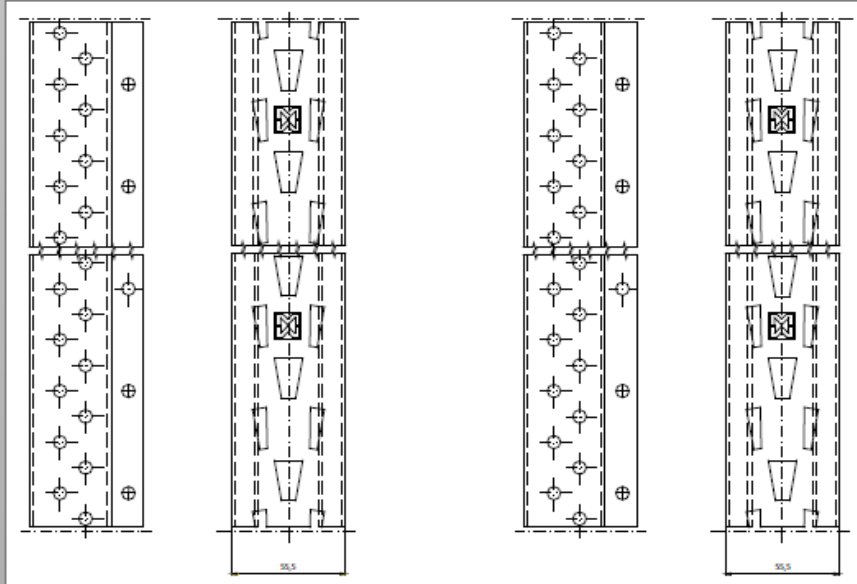

H = 2200 - 2700 - 3200 - 3700 - 4200 - 4700 - 5200 - 5700 - 6200 - 6700 - 7200 - 7700 - 8200

Simple base plate

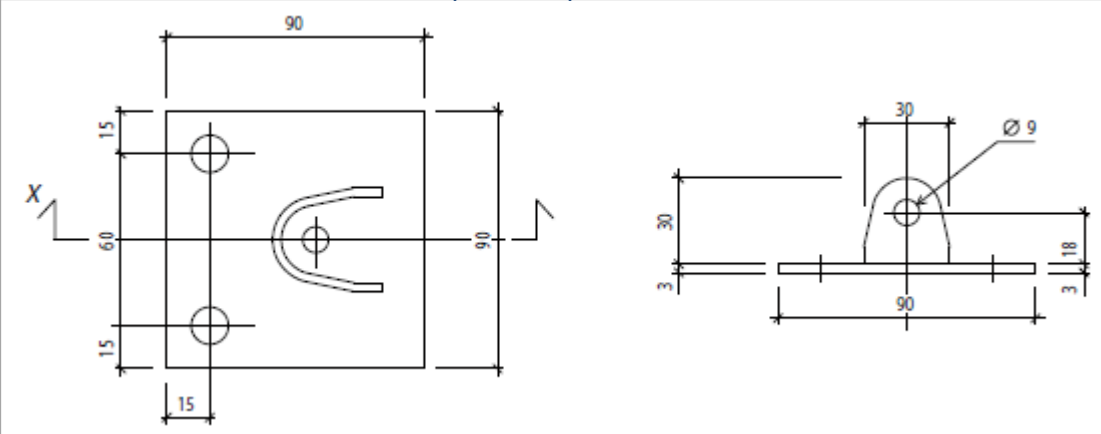

Base plate for installations

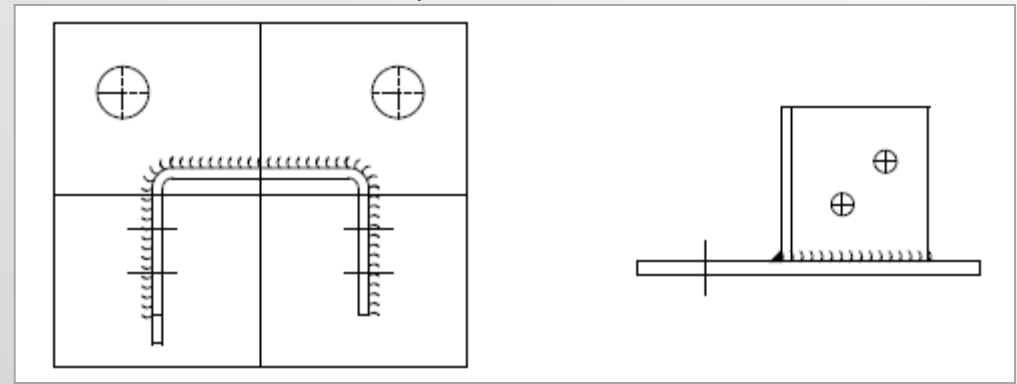

Wall anchor

Beam stopper

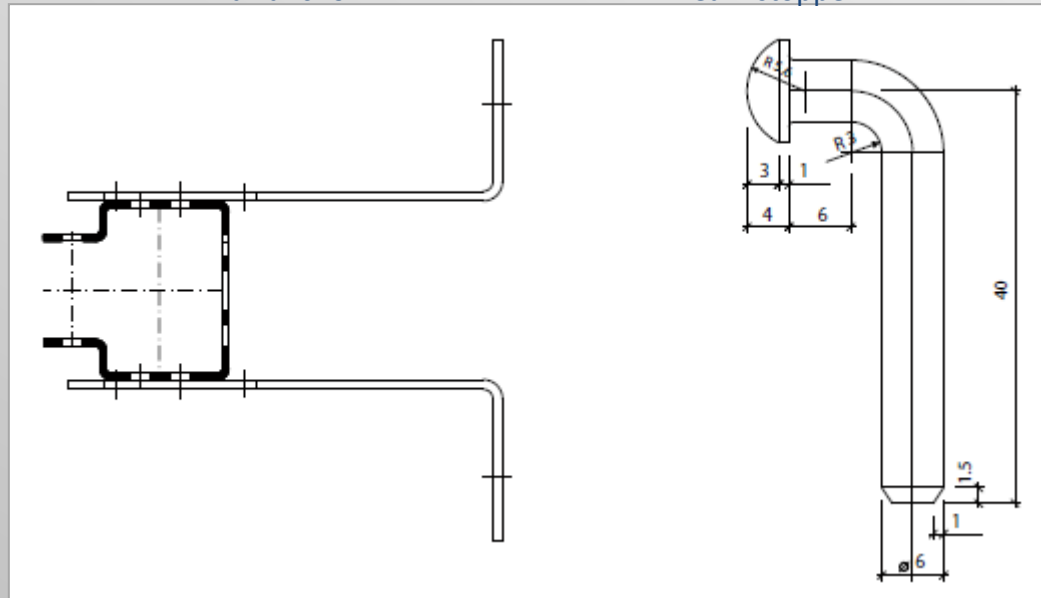

Beam thickness 1.5 mm

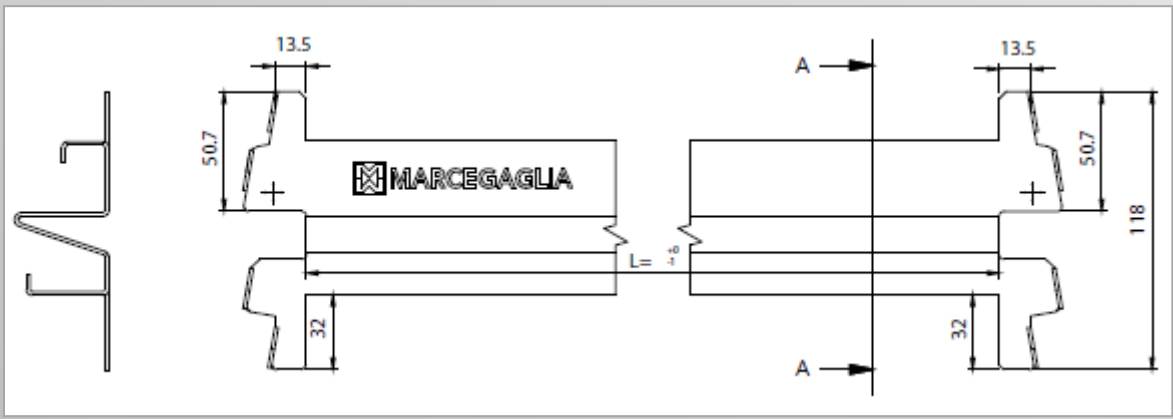

Standard beams for tiles 100 and 200 LBB

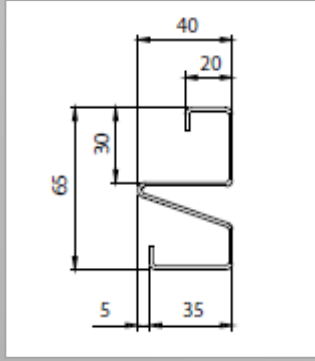

Normal length	Q load capacity kg
1200	800
1500	770
1800	600
2000	480
2400	320

Standard beams for panels LBB 100-200-300

Code	Nominal length	L = mm	Q load capacity kg	Weigh kg
3681900915	1200	1205	800	2,72
3681901515	1500	1505	770	3,39
3681901715	1600	1605	740	3,61
3681902125	1800	1810	600	4,06
3681902525	2000	2010	480	4,50
3681902725	2100	2110	430	4,72
3681903325	2400	2410	320	5,39

## Tile planks

Tiles

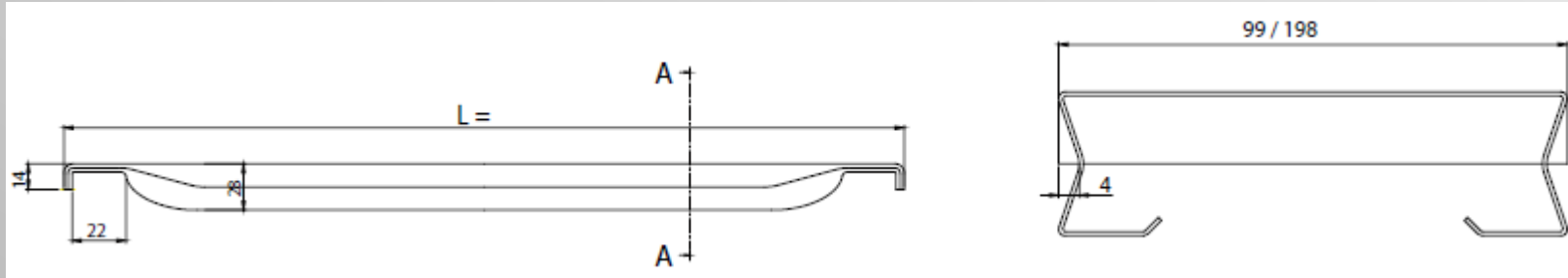

Tiles light Bi-Bloc thickness 0,6

Tiles light Bi-Bloc thickness 0,6

Tiles 200 LBB	Load capacity kg. C.u.d.	Tiles 100 LBB	Load capacity kg. C.u.d.
200 x 400	130	100 x 400	130
200 x 500	115	100 x 500	115
200 x 600	100	100 x 600	100
200 x 800	80	100 x 800	80
200 x 1000	60	100 x 1000	60
200 x 1200	50	100 x 1200	50



**Tiles for fitting on beams with Light Bi-Bloc panels**

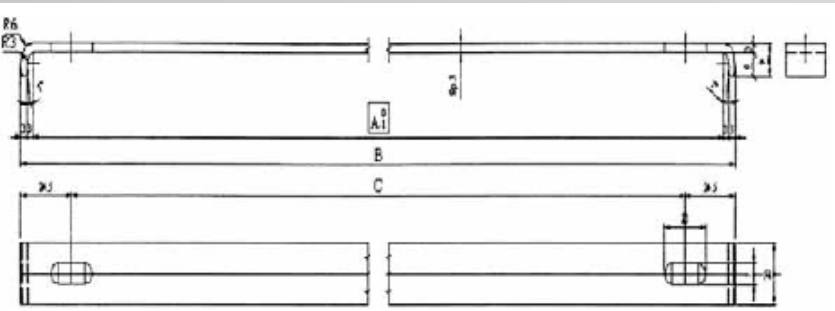

**Load capacity Light Bi-Bloc shelves with Errex panels 100, thickness 0,6 (with anti-torsion tie)**

Nominal length (mm)	Length (mm)	N.of panels 100	Beams load capacity	Panels load capacity (kg)					
				110	100	90	75	60	50
				Upright frame depth (mm)					
				400	500	600	800	1000	1200
1000	1005	10	800	800	800	800	800	800	800
1100	1105	11	800	800	800	800	800	800	800
1200	1205	12	800	800	800	800	800	800	800
1300	1305	13	800	800	800	800	800	800	800
1400	1405	14	800	800	800	800	800	800	800
1500	1505	15	770	770	770	770	770	770	770
1600	1605	16	740	740	740	740	740	740	740
1700	1705	17	660	660	660	660	660	660	660
1800	1810	18	600	600	600	600	600	600	600
1900	1910	19	520	520	520	520	520	520	520
2000	2010	20	480	480	480	480	480	480	480
2100	2110	21	430	430	430	430	430	430	430
2200	2210	22	400	400	400	400	400	400	400
2300	2310	23	360	360	360	360	360	360	360
2400	2410	24	320	320	320	320	320	320	320
2500	2510	25	300	300	300	300	300	300	300



Thank you for your attention!  
We welcome your questions, you can find us at:  
[office@stamh.com](mailto:office@stamh.com)

Further information:  
[www.stamh.com](http://www.stamh.com)

STAMH Ltd., 126 Tzar Boris III Blvd. 9<sup>th</sup> floor, Sofia, Bulgaria  
Tel: 02 955 56 42, 02 955 54 99, fax: 02 955 56 47; e-mail: [office@stamh.com](mailto:office@stamh.com)